

Instruction

Color

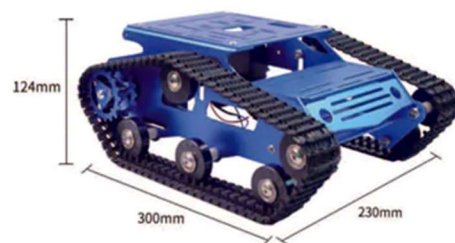

Size



Parameters

Product Name	Tank Chassis	Material	Aluminum Alloy+ABS
Color	Blue/Green/Red Gold/Black/Orange	Craft Process	Electroplate
Input voltage	12V	Motor Speed	160r/min
Degree of climbing	30°	Working Type	Crawler-type
Size	300x230x124mm(LxWxH)	Weight	1.20Kg

A variety of circuit mounting holes



List of parts and tools

Accessories list and tools

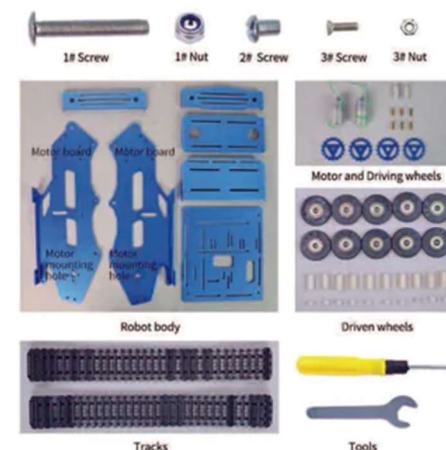

Tips

This product needs to first install the motor, use the 3# screw to fix the motor to the car body, use the 1# screw nut to install the driven wheel, and use the 2# screw to install the driving wheel.

Installation of Motor

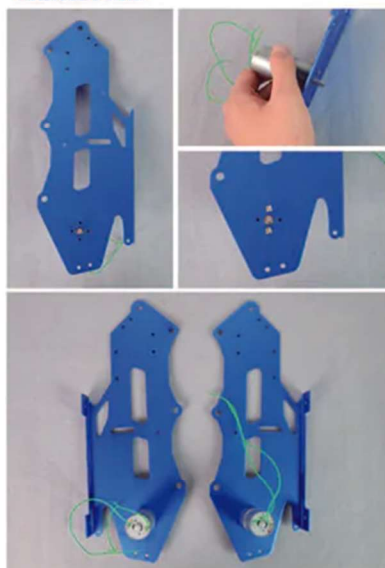

First insert the motor into the motor mounting hole of the motor board, then rotate the motor to align the cross hole, and place two 3# screws into the hole position, and the other motor will operate in the same way.
Note: Pay attention to the direction of the motor insertion during installation.

Robot body assembly

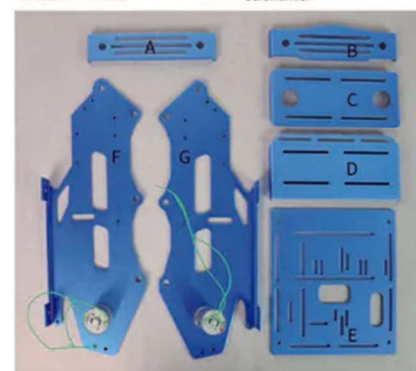

Assembly of E/F/G

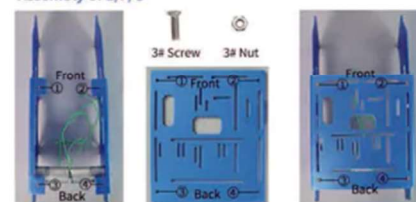

Please pay attention to the direction of part E

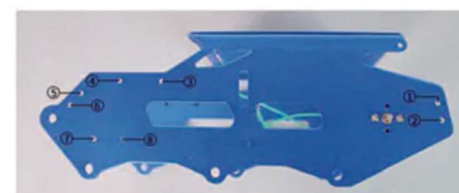

①② corresponds to part A
③④ corresponds to part D
⑤⑥ corresponds to part B
⑦⑧ corresponds to part C
Please pay attention to the direction of part B and D

Installation of Part A

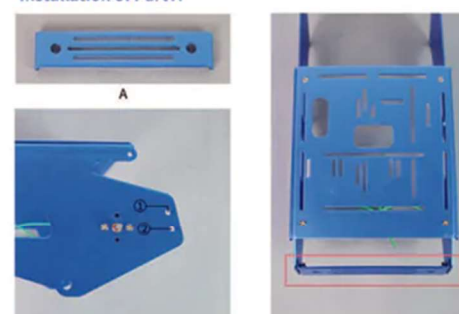

Use 3# screw and nut to fix part A

finished product

Installation of Part D

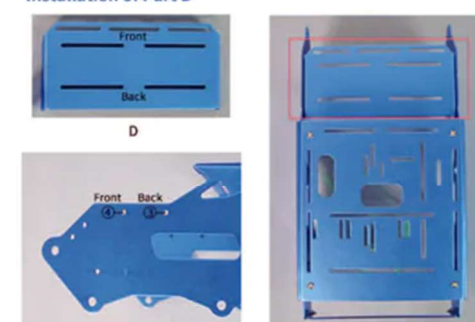

Use 3# screw and nut to fix part D

finished product

Installation of driven wheel

Installation of Part B



B

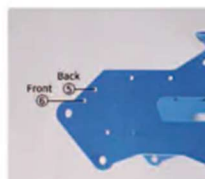

Use 3# screw and nut to fix part B



finished product

Installation of Part C



C



Use 3# screw and nut to fix part C



finished product

Screw+Tool



A set of fittings for driven wheels

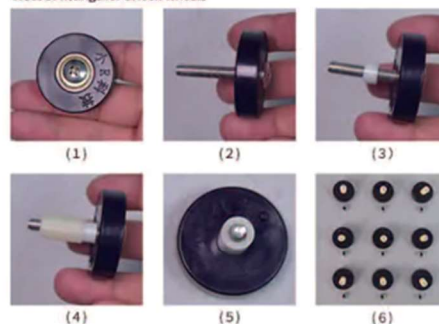

First, the 1# screw is passed through the side of the wheel with the iron ring. Second, put a short hollow plastic column on the 1# screw and bring it to the bottom. Third, put a long hollow plastic column on the 1# screw. Fourth, according to the above steps, assemble the other 9 wheel that need to be used, and prepare the 1# nut.

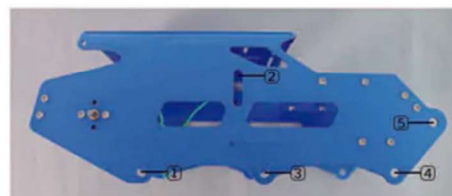

As shown in the picture: fix the driven wheel in 5 positions with 1# screw and 1# nut.

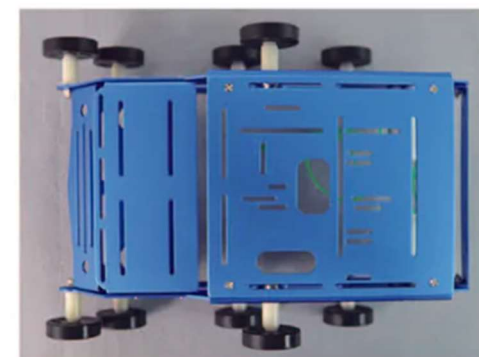
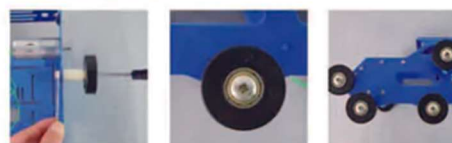

Since the 1# screw is more difficult to twist, it will be assisted by a wrench. Note: No. 2 hole is a long rounded rectangle. The wheel must be installed at the top of the hole.

Driving wheel installation

Screw+Tool

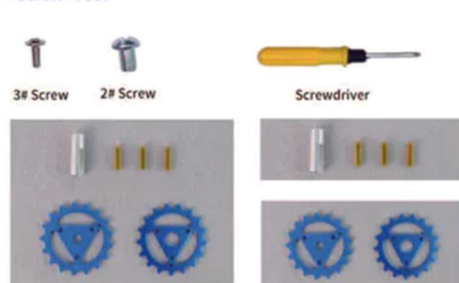

The list of parts of a driving wheel

Driving wheel

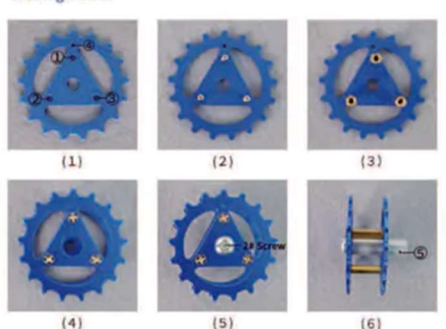

Fix the copper pillar in ①②③ with 3# screw
The small hole on the two gears must be aligned
Fix the 2 gears in center coupling with 2# screw
The ⑤ use to fix the driving wheel to the coupling

Driving wheel installation

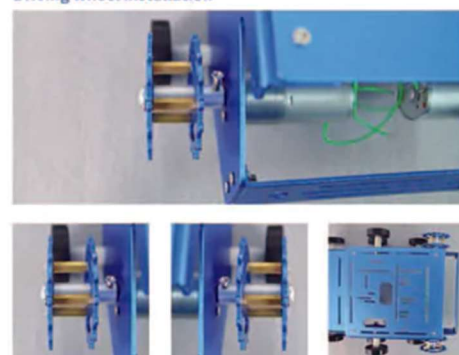

Use the 3# screw to fix the driving wheel to the motor shaft

Fix the crawler onto the wheel

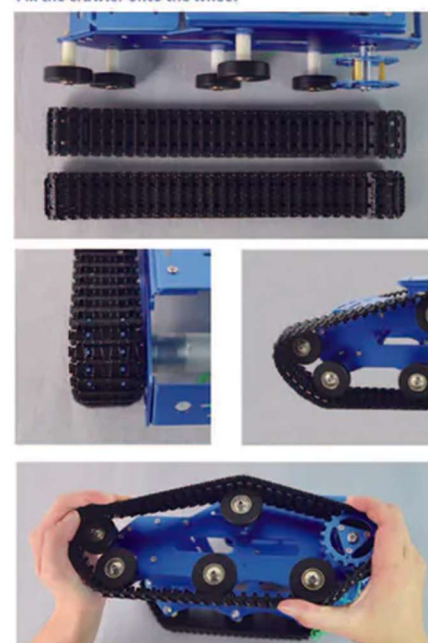

Finished product

