

Hello! Otto Builder

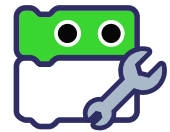

I am Otto, your new robot friend. Ready to build me?

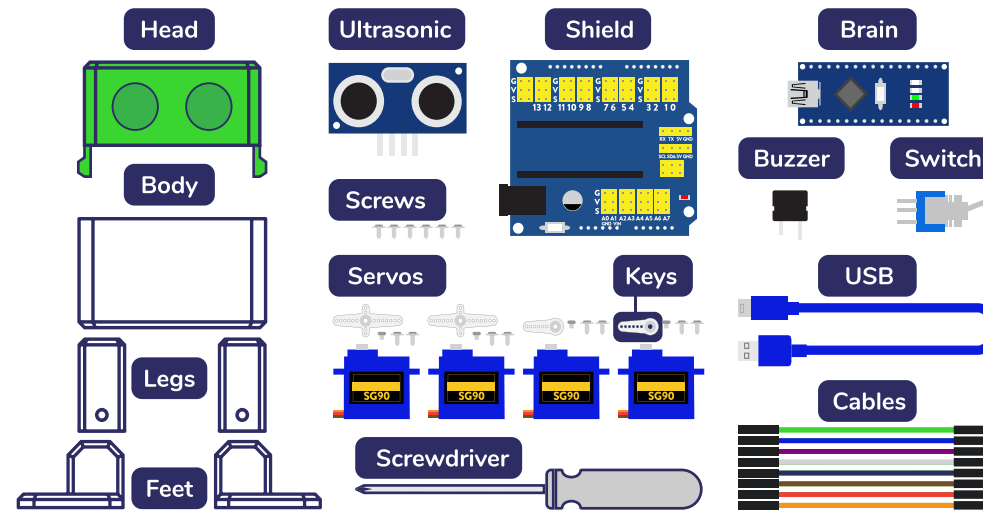

1

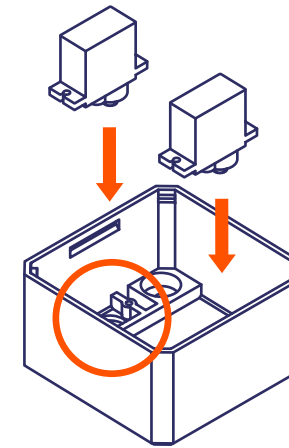

2

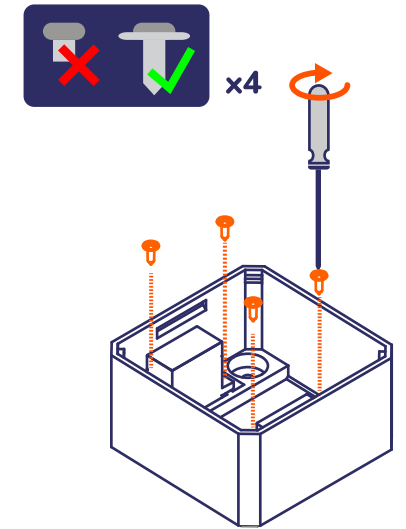

3

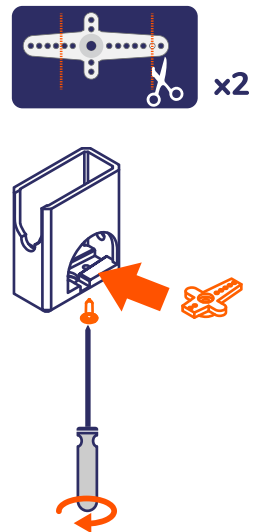

4

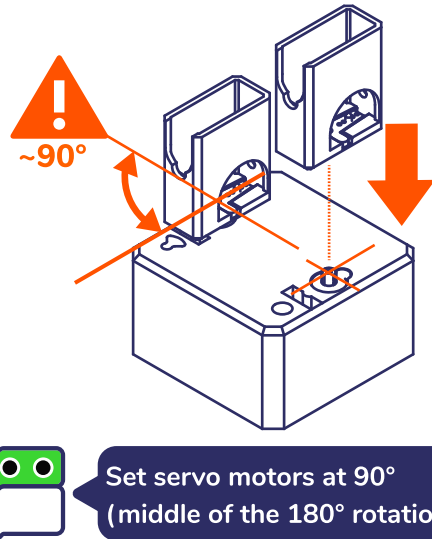

Set servo motors at 90° (middle of the 180° rotation).

5

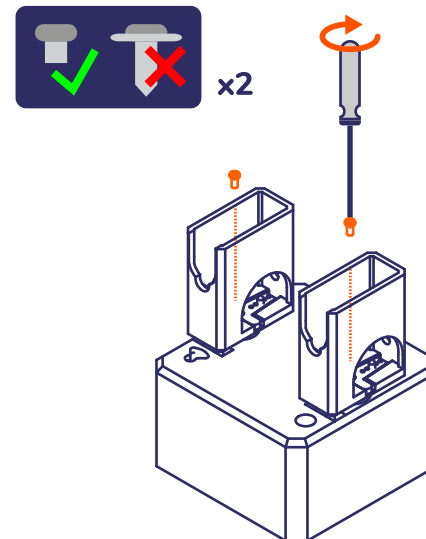

6

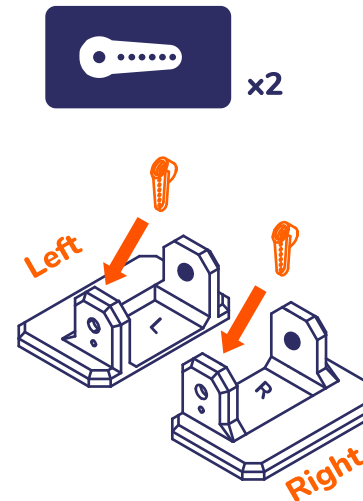

7

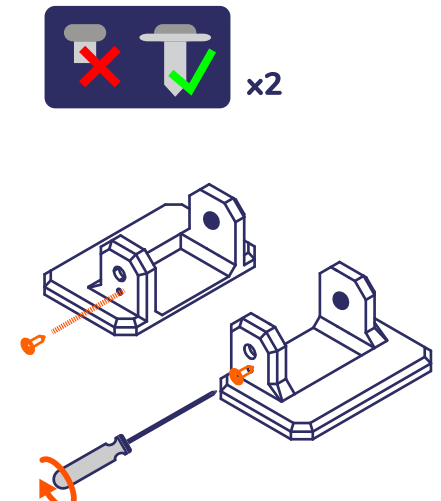

8

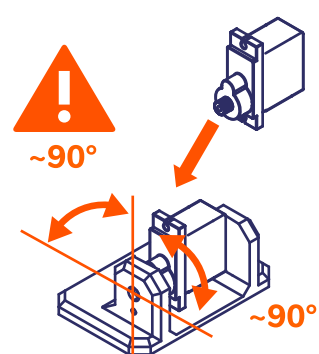

9

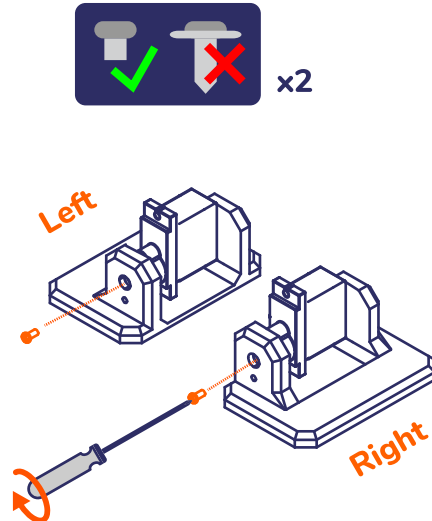

10

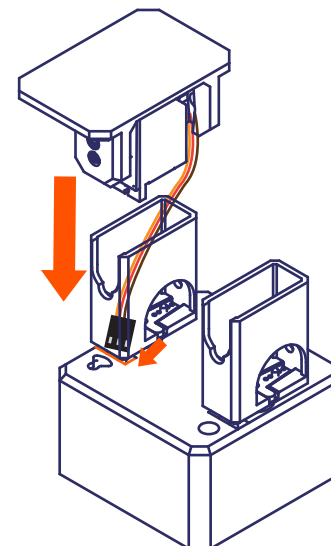

11

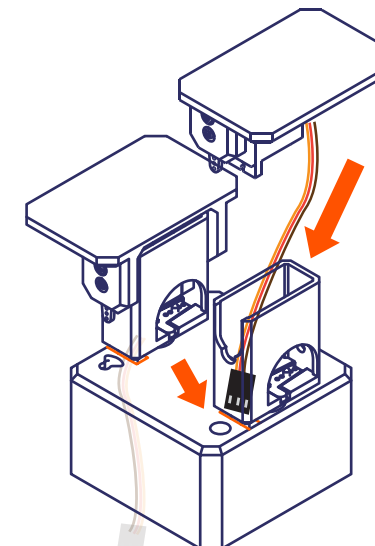

12

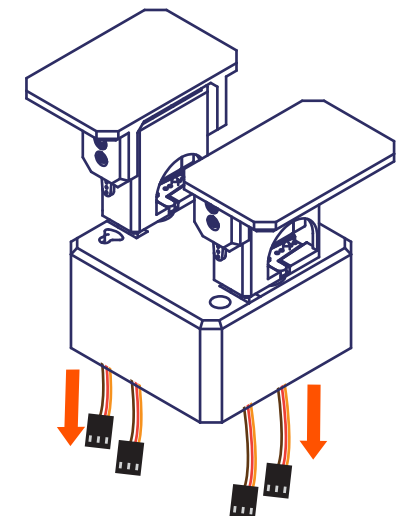



Set servo motors at the middle of the 180° rotation.

WARNING: CHOKING HAZARD
Small parts: NOT for Children under 3 years

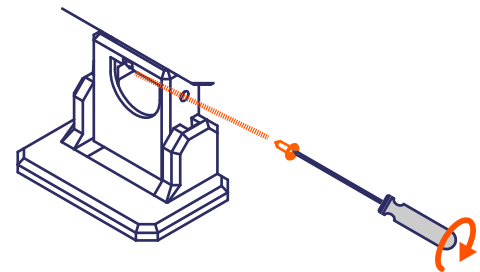

13  x2



 This screw is tricky but you can do it!

14

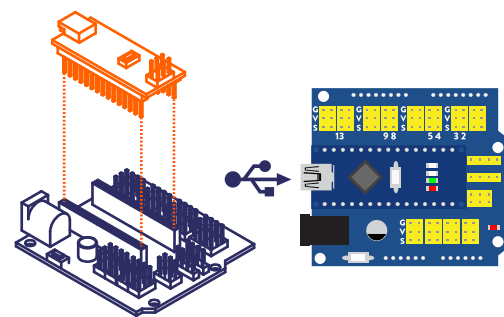

 Make sure the USB connector is facing left.

15

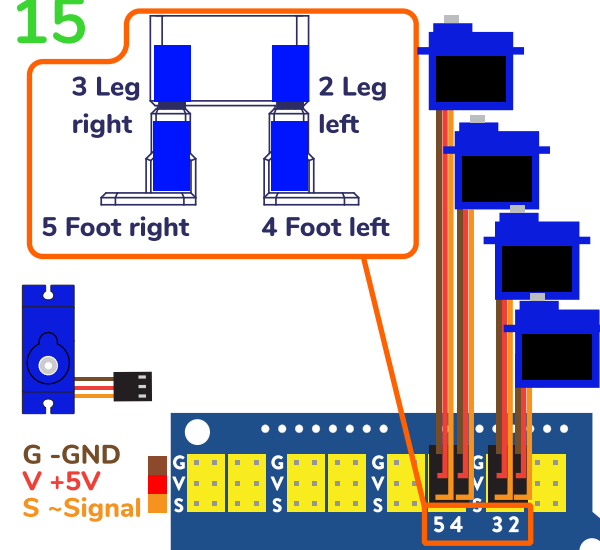

16

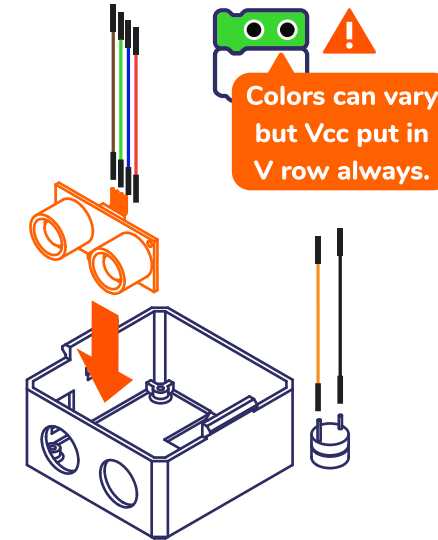

17

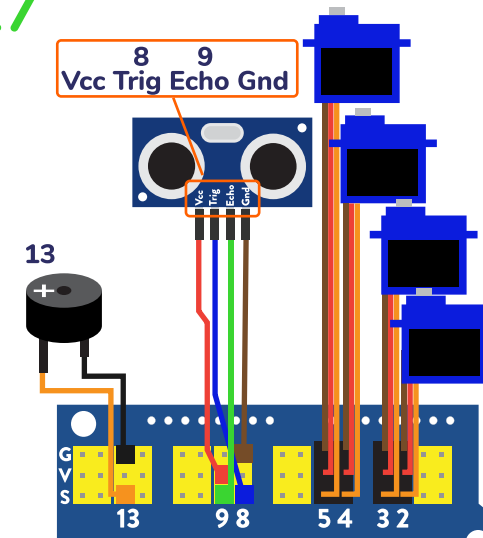

18

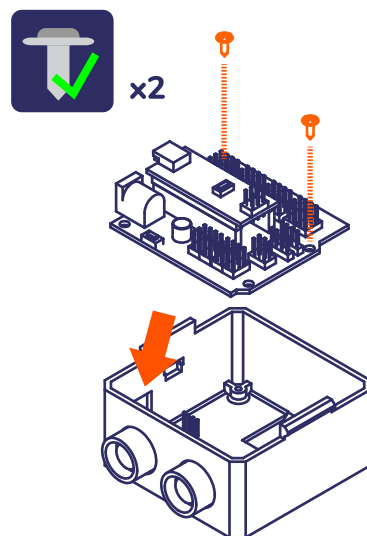

19

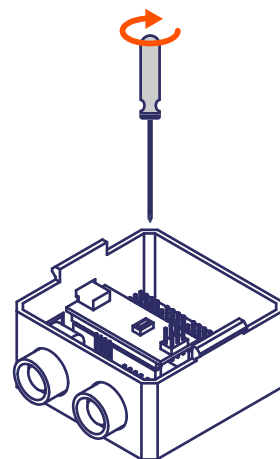

20

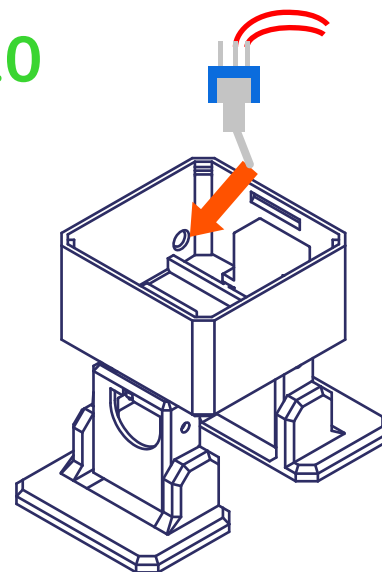

21

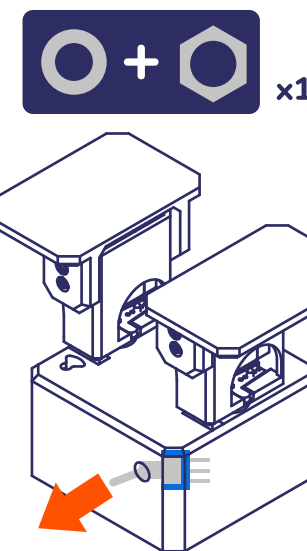

22

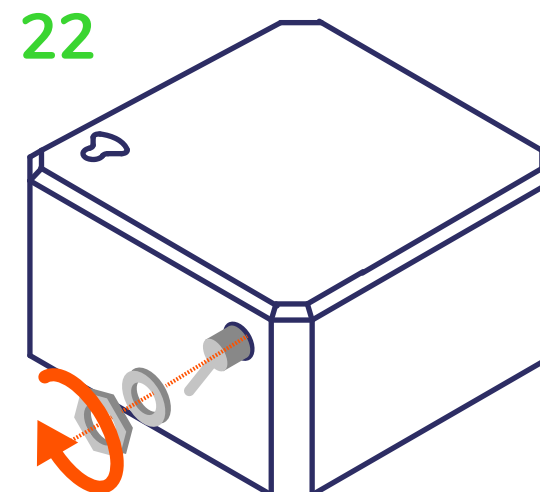

23

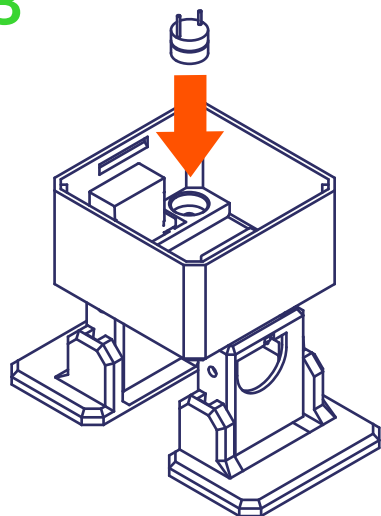

24

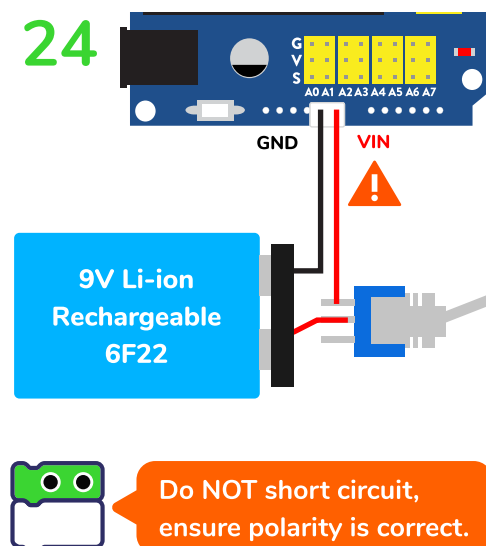

25

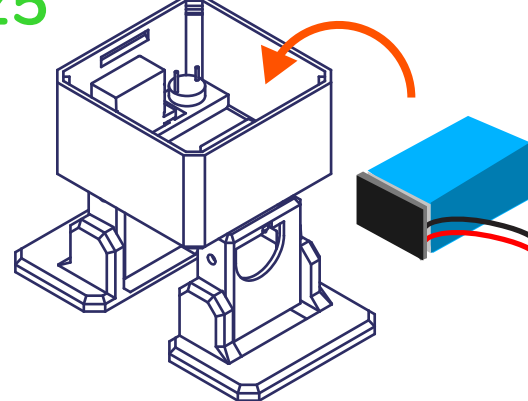

26

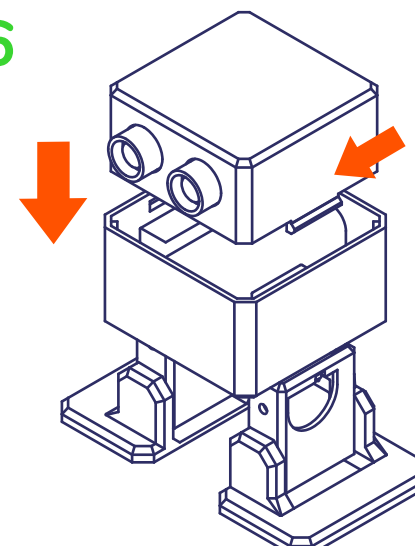

27

