

**4 Stage Viper-Slide Kit
(Belt-Driven)
3210-0003-0004
Assembly Instructions**

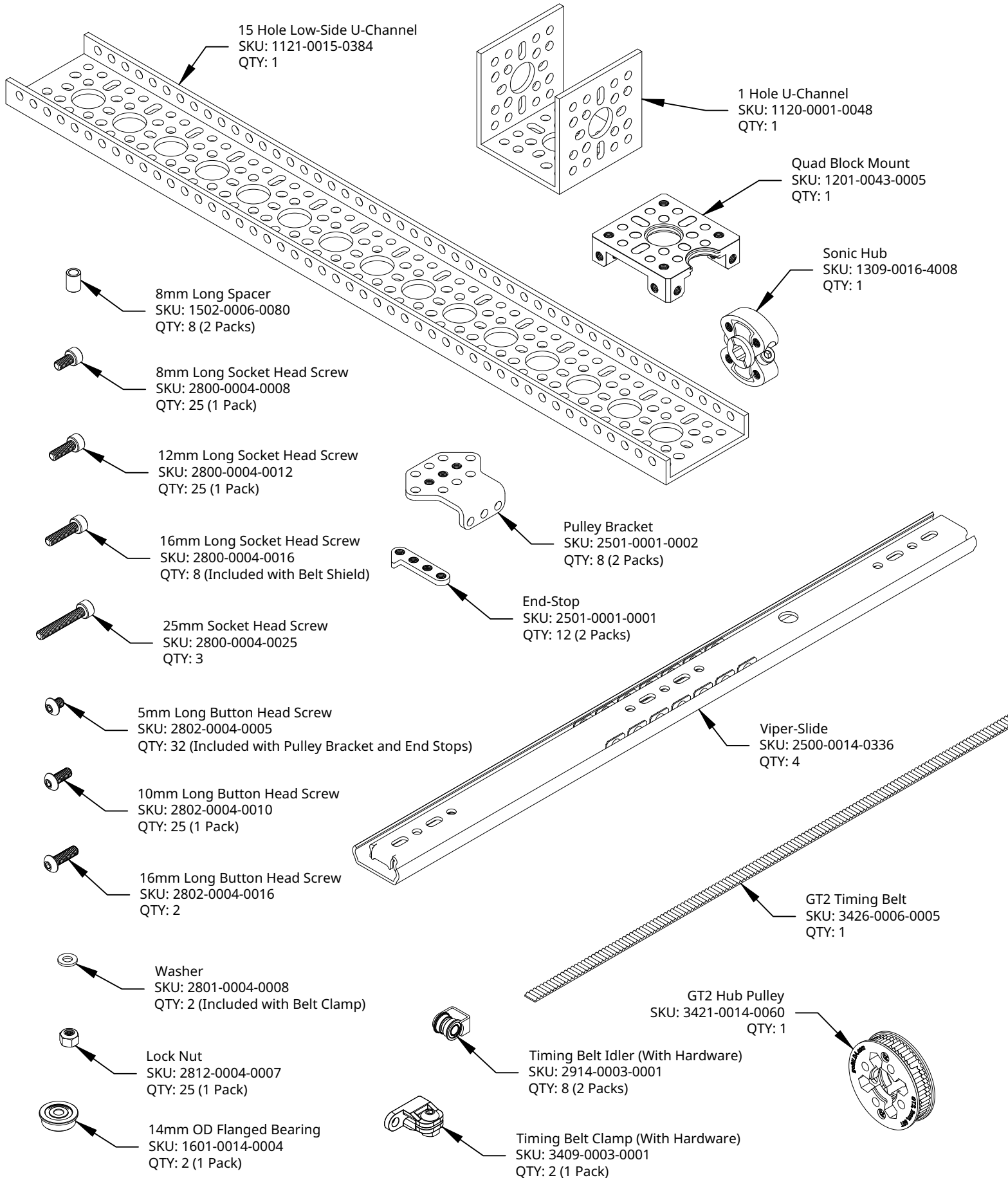

Kit Contents:



Step 1:

Disassemble all four Viper-Slides by sliding the inner piece out of the outer piece in the opposite direction as it would extend smoothly. It will take some effort as the inner piece and the ball bearings must slide against each other. Keep parts from each slide paired together.

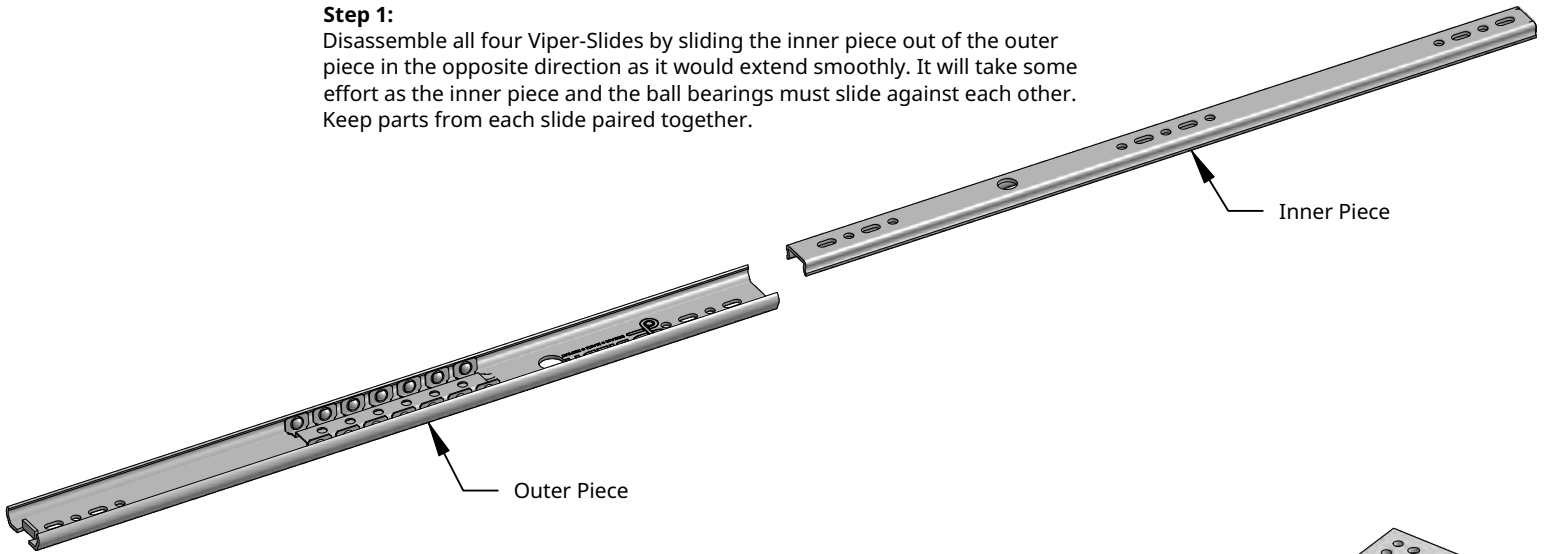

Step 2

Attach the outer piece of the first Viper-Slide to the 15 Hole Low-Side U-Channel using four 10mm Button Head Screws and four lock nuts.

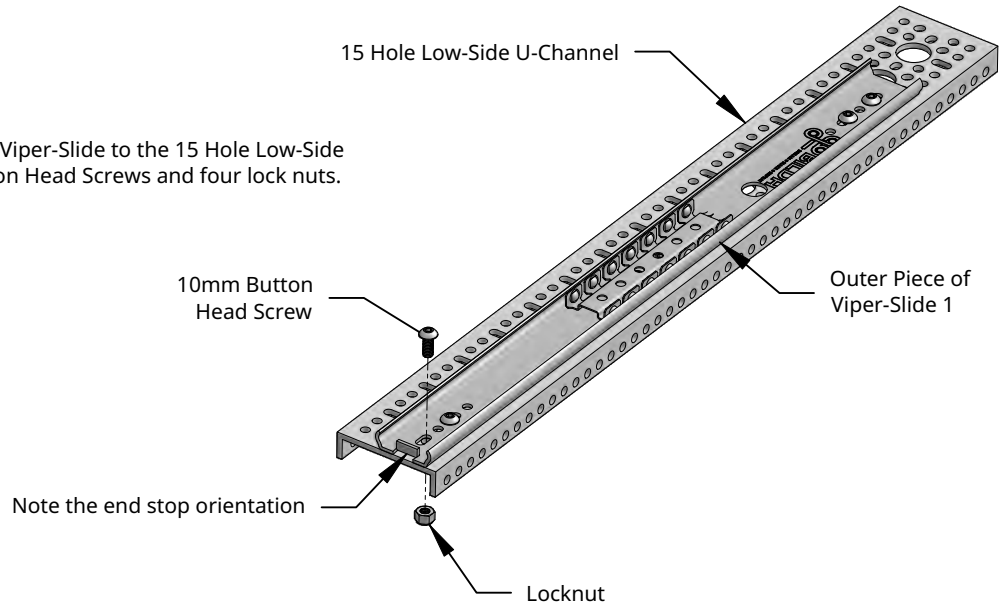

Step 3

Using nine 5mm Screws, bolt the inner piece of slide 1 and the outer piece of slide 2 to two Pulley Brackets and an End-Stop Plate.

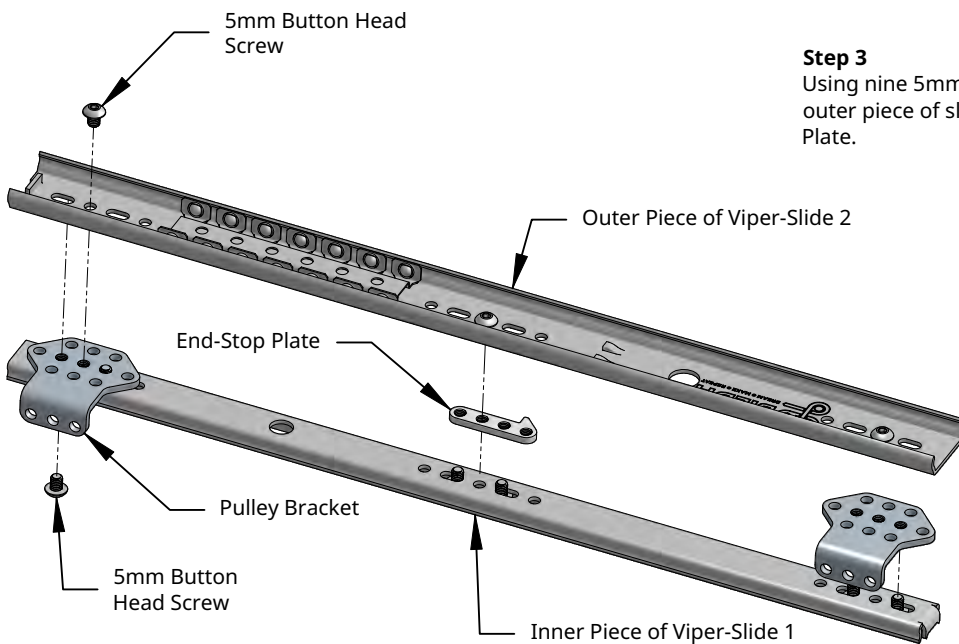

Repeat Step 3 twice to create 3 identical subassemblies.

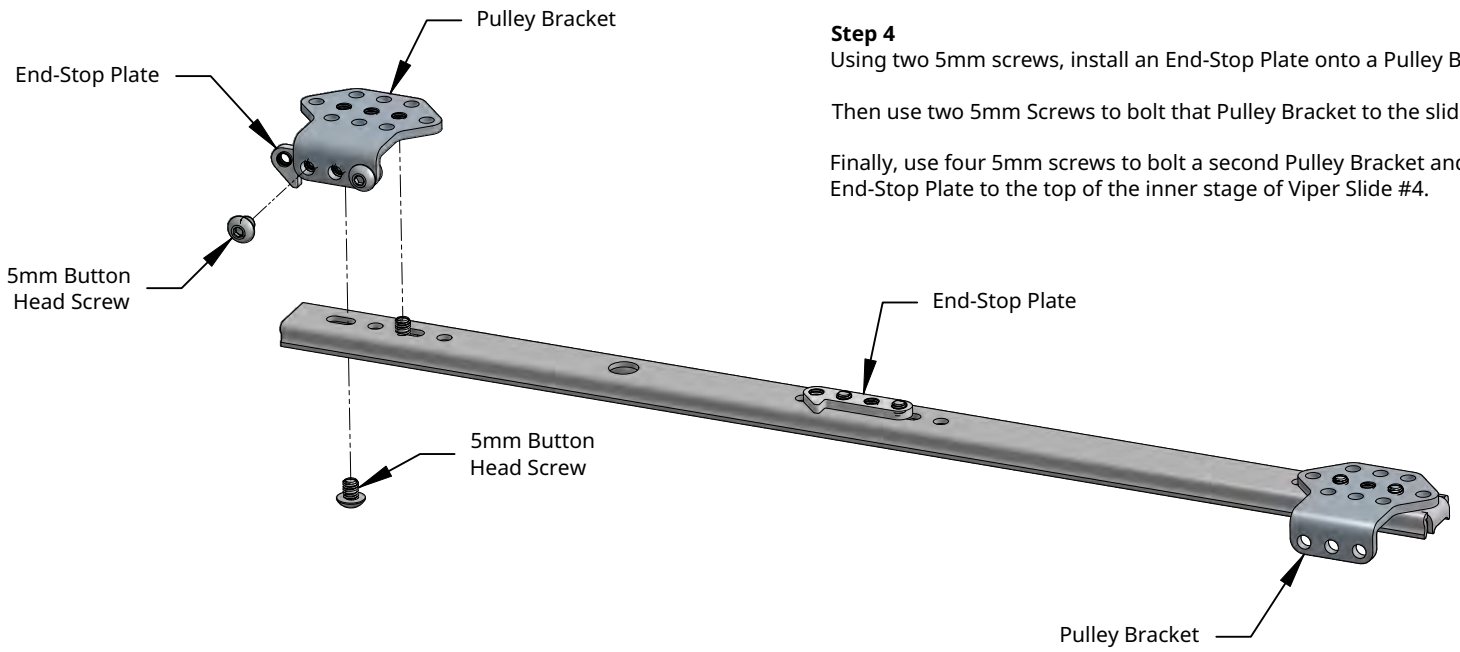

Step 4

Using two 5mm screws, install an End-Stop Plate onto a Pulley Bracket.

Then use two 5mm Screws to bolt that Pulley Bracket to the slide.

Finally, use four 5mm screws to bolt a second Pulley Bracket and an End-Stop Plate to the top of the inner stage of Viper Slide #4.

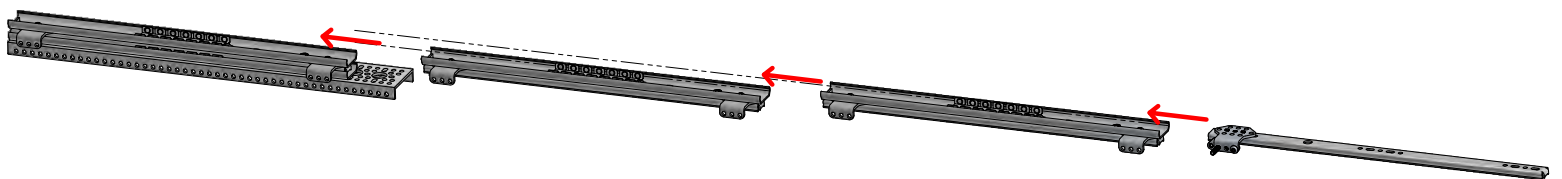
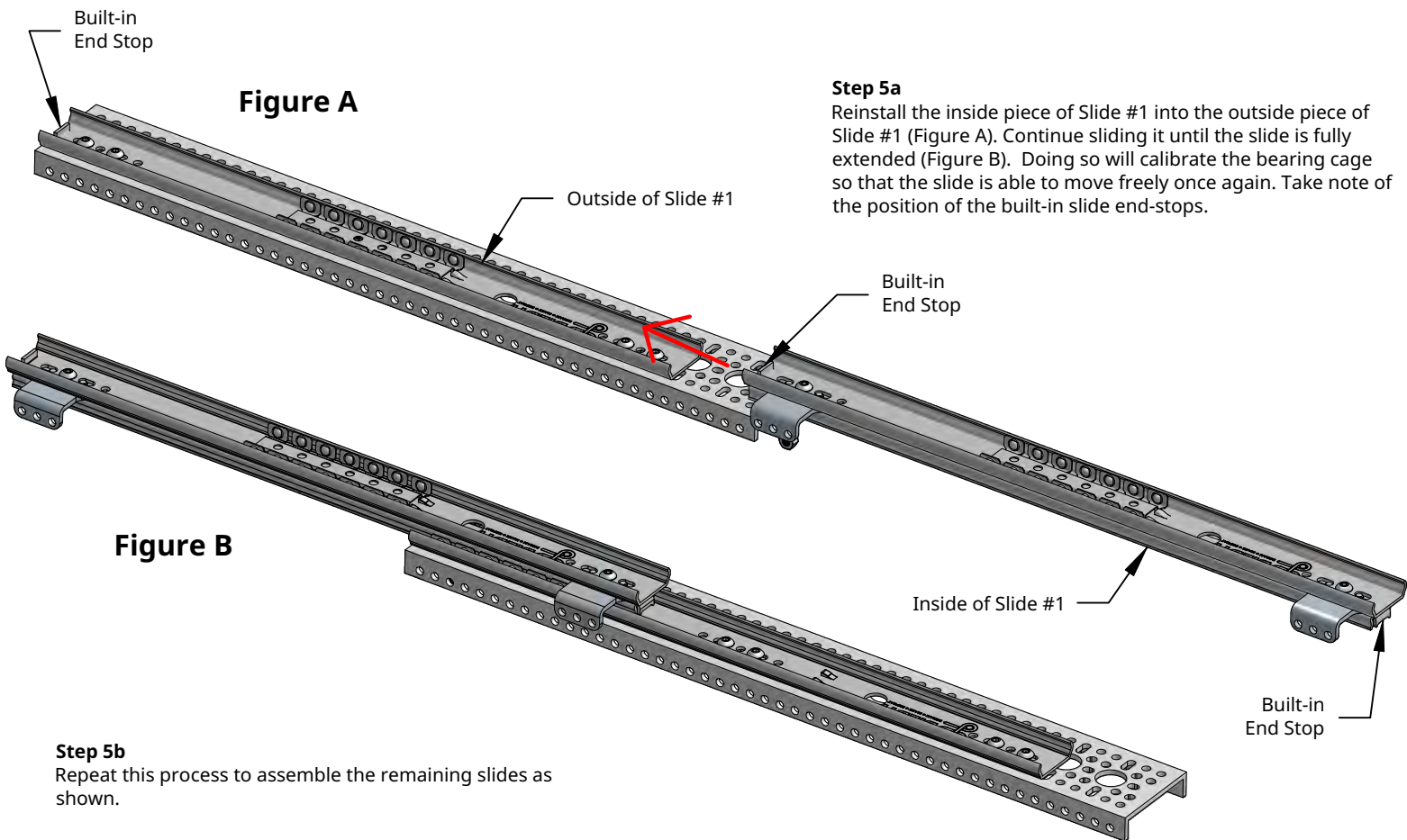

Step 6

Using four 12mm Socket Head Screws, bolt a 5203 Series Yellow Jacket to the Quad Block before installing the Sonic Hub and Winch Pulley to the motor shaft approximately 8.5mm from the face of the Quad Block.

Tech Tip: This is slightly farther than an 8mm long spacer. You can use one to measure the distance.

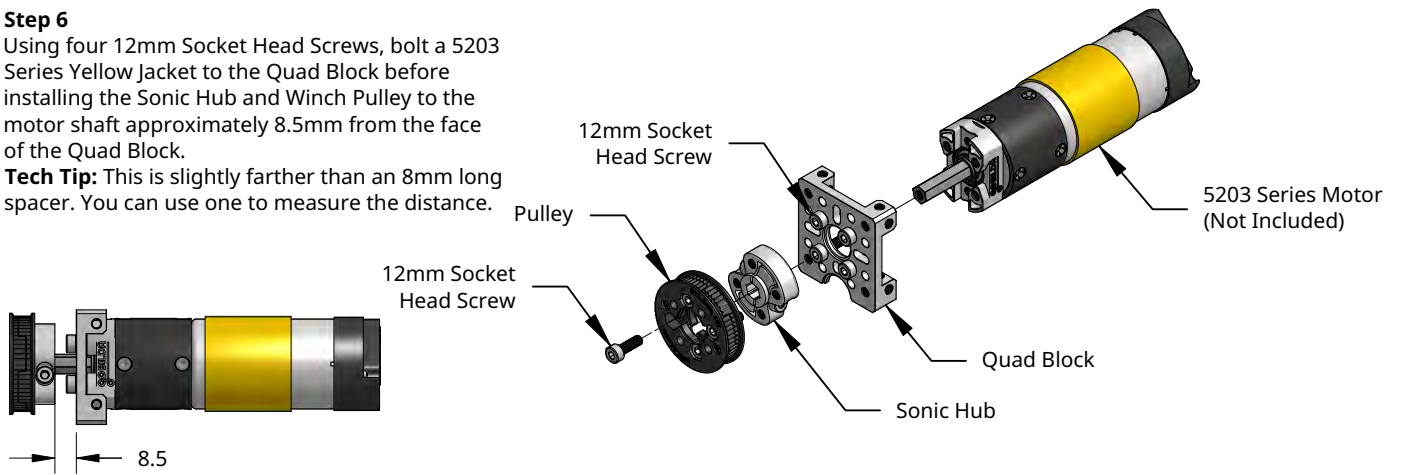

Step 7

Install a U-Channel around the Quad Block that the motor from the previous step is mounted to. Secure it using three 12mm Socket Head Screws.

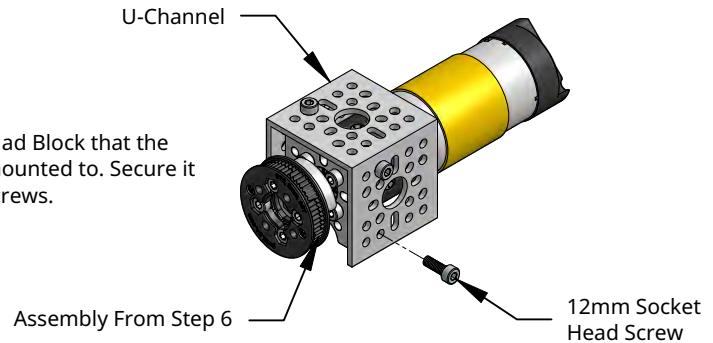

Step 8

Using two 8mm Socket Head screws, bolt the assembly you created in step 7 to the U-Channel.

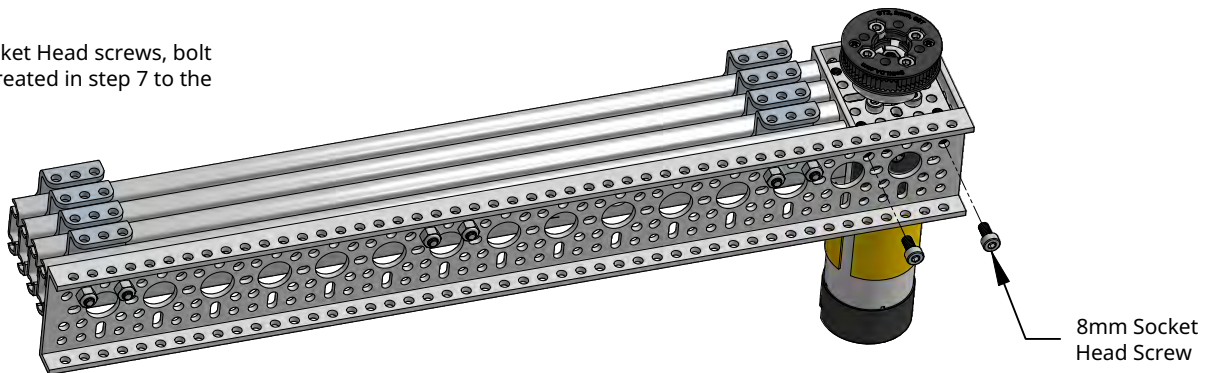

Step 9

Attach two bearings and and Shield (with a Shim and Spacer shown in Figure B) to the side of the Low-Side U-Channel 3 holes from the far end, and 9 holes from the near end. Note the orientation of the shields.

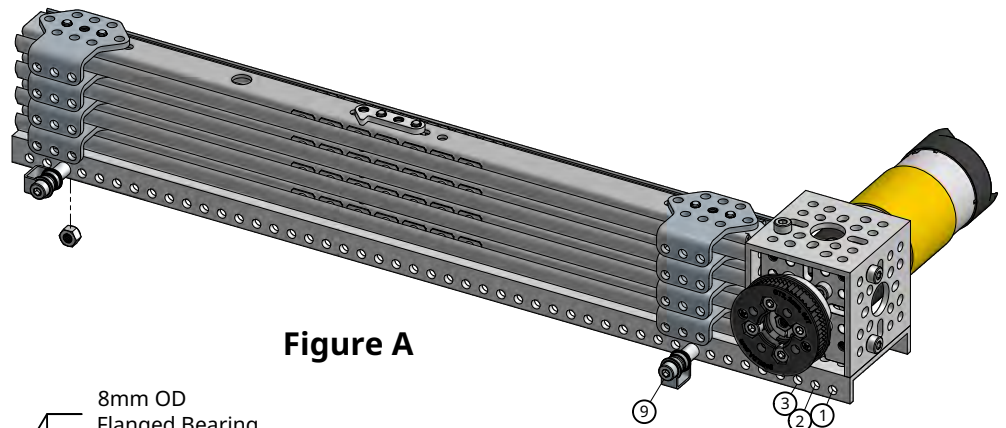

Figure A

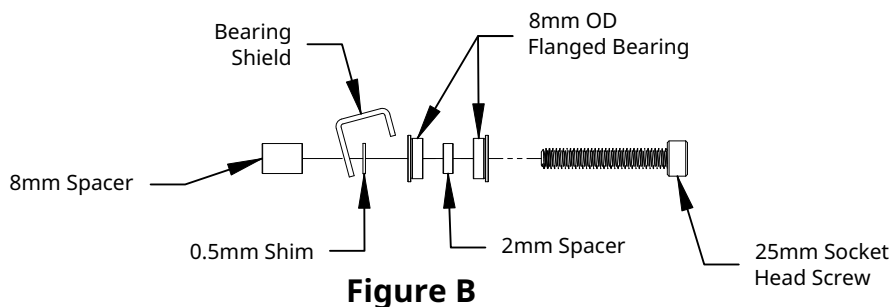
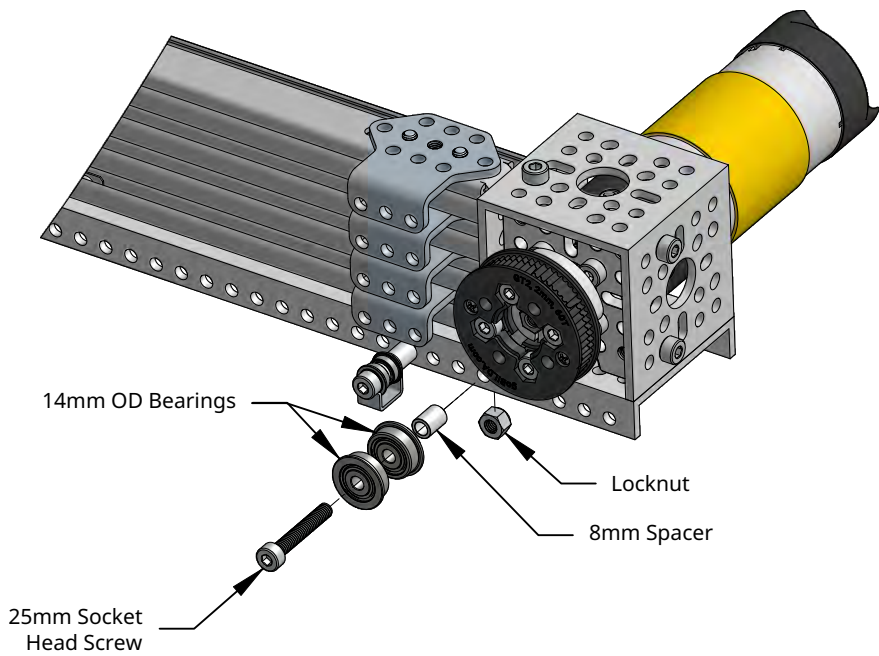

Figure B



Step 10
Install 2 Flanged Bearings on a Spacer, using a 25mm Screw on the 6th hole from the near end of the Low-Side U-Channel

Step 10
Using six 5mm screws, attach the six remaining End-Stop Plates behind the Pulley Brackets. Take note of their orientation. Using six 14mm screws, attach six Timing Belt Idlers (with their included hardware as shown in Figure B) to the Pulley Brackets.

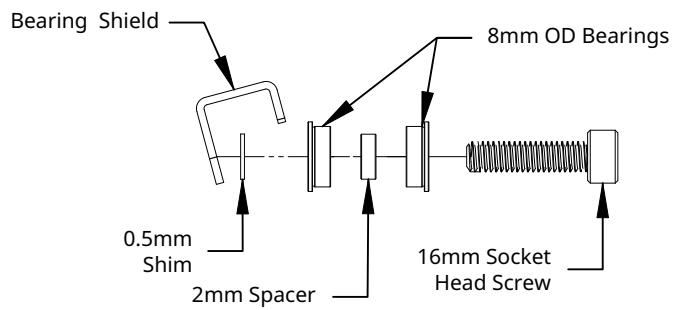
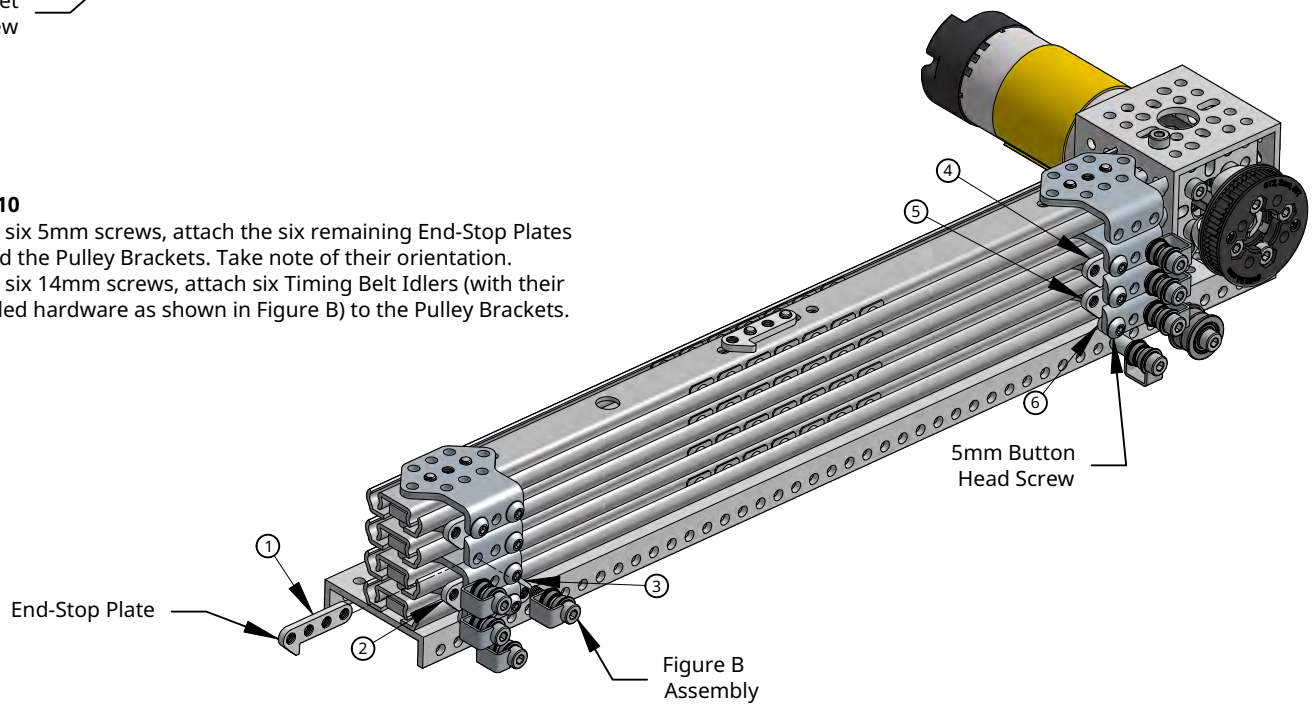

Figure B

After this step, your kit is complete! Please check out this QR Code or URL for a rigging guide video!
https://youtu.be/qq6sZw4_YaQ

